



## Operating instructions

Please keep these instructions in a safe place!

CE 0682

**elero USA**  
10827 Alder Circle  
USA-Dallas  
Texas 75238  
info@eleroUSA.com

**elero GmbH**  
Antriebstechnik  
Linsenhofer Str. 59-63  
D-72660 Beuren  
info@elero.de  
www.elero.com

Safety instructions .....	USA- 2
Instruction to the user .....	USA- 3
Explanation of buttons .....	USA- 4
General information .....	USA- 5
Designated use .....	USA- 5
Notes .....	USA- 6
Wall holder installation .....	USA- 6
Explanation of functions .....	USA- 7
Manual/Automatic sliding switch .....	USA- 7
Transmission control light .....	USA- 7
Group control .....	USA- 7
Programming radio channel settings .....	USA- 8
Programming transmitter/channel .....	USA- 8
Programming additional transmitters .....	USA- 8
Intermediate position for roller shutter/awning/ venetian blind .....	USA-10
Programming intermediate position .....	USA-10
Programming ventilation/reverse position .....	USA-10
Adjustment to intermediate position .....	USA- 11
Adjustment to ventilation/reverse position .....	USA- 11
Deleting intermediate position .....	USA- 11
Deleting ventilation/reverse position .....	USA- 11
Deleting radio channel settings .....	USA-12
Deleting individual transmitters .....	USA-12
Deleting all transmitters .....	USA-12
Technical data .....	USA-13
Cleaning .....	USA-13
Battery replacement .....	USA-13
Troubleshooting .....	USA-13
General declaration of conformity .....	USA-13



Warning!

### Important safety instructions!

The following instructions must be observed at all times.

- For use in dry rooms only.
- Use unmodified **elero** original parts only.
- Keep persons away from the systems guide track.
- Keep children away from controls.
- Always comply with national stipulations.
- Always dispose of used batteries properly. Always replace batteries with identical type (LR 03; AAA).
- If the system is controlled by one or more transmitters, the system guide track must be visible during operation.
- The equipment contains small parts that could be swallowed.

This equipment has been tested and found to comply with the limits for a class B digital device, pursuant to part 15 of the FCC Rules. These limits are designed to provide reasonable protection against harmful interference in a residential installation. This equipment generates, uses and can radiate radio frequency energy and if not installed and used in accordance with the instructions, may cause harmful interference to radio communications. However, there is no guarantee that interference will not occur in a particular installation. If this equipment does cause harmful interference to radio or television reception, which can be determined by turning the equipment off and on, the user is encouraged to try to correct the interference by one or more of the following measures:

- Reorient or relocate the receiving antenna.
- Increase the separation between the equipment and receiver.
- Connect the equipment into an outlet on a circuit different from that to which the receiver is connected.
- Consult the dealer or an experienced radio/TV technician for help.

Operation with non-approved equipment is likely to result in interference to radio and TV reception. The user is cautioned that changes and modifications made to the equipment without the approval of manufacturer could void the user's authority to operate this equipment.

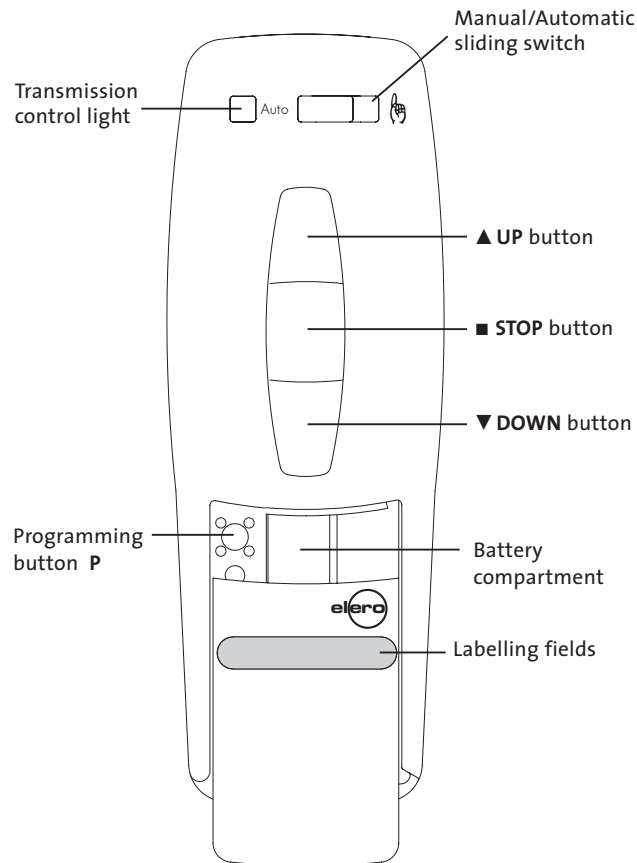

### General information

The LumeroTel-915 handheld transmitter can be used to operate one or more receivers.  
This device is characterised by its user-friendly operation.

### Designated use

The LumeroTel-915 device may be used to operate roller shutters/sun protection systems **only**.

- Please note that radio-controlled systems may **not** be used in areas with a high risk of interference (e.g. hospitals, airports).
- The remote control is intended solely for use with equipment and systems in which malfunctions in the handheld transmitter or receiver would not pose any risk to persons, animals or property or which contain safety devices to eliminate such risks.
- The operator is not protected from interference from other telecommunications systems and terminal equipment (e.g. even from radio-controlled systems which are properly operated in the same frequency range).
- Radio receivers may only be used in combination with equipment and systems stipulated in manufacturers' specifications.

**Note:** Radio base stations transmitting in the same frequency range may cause reception interference.

Please note that the operating range of the radio signal is limited by legislation as well as by the product design.

### Wall holder installation

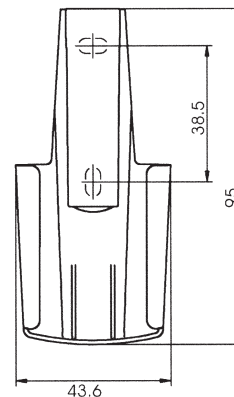

- Before installing the wall holder, always ensure that the transmitter and receiver are in proper working order.
- Mount the holder onto the wall using the two raw plugs and screws provided.

### Manual/Automatic sliding switch

The sliding switch is used to switch the receivers into either manual or automatic mode.

When the sliding switch is set to automatic mode, the receivers will respond to every signal transmitted, whereas in manual mode they will only respond to UP, STOP and DOWN control commands, as well as to wind alarm signals.

### Transmission control light

The transmission control light is illuminated when a radio signal is being transmitted.

The transmission control light will flash during transmission if battery power is low.

The transmission power or radio operating range will decrease as battery power decreases. If the transmission control light does not light up when the buttons are pressed, the batteries must be replaced.

### Group control

Group control refers to the operation of one or more receivers at the same time. The group selected is controlled via a control command.

The LumeroTel-915 operates the chosen group via a radio channel.

**Note:** The inlay card beneath the transparent cover can be used to make a note of the groups which have been programmed.

### Programming transmitter/channel

**Prerequisite:** The receiver must be installed.

1. With pre-installed electric receivers, the fuse must be disconnected and reconnected after a few seconds. The receiver will remain in programming mode for approximately 5 minutes.
2. Position yourself in front of the roller shutter/awning/blind with the remote control in your hand.
3. Open the front cover of the device and press the transmitter programming button **P** briefly. The shutter/awning/blind will start to move up and down. This will happen for approximately 2 minutes.
4. To define the keyboard layout, press the **UP** button on the transmitter as soon as the shutter/awning/blind begins to move upwards (after approx. 1 second). The shutter/awning/blind will come to a halt briefly.  
As soon as the shutter/awning/blind begins to move again, press the **DOWN** button on the handheld transmitter.  
The shutter/awning/blind will come to a stop.  
The transmitter or this channel has been successfully programmed.

### Programming additional transmitters

To programme additional transmitters in one receiver, please proceed as follows:

1. Press the **UP**, **DOWN** and programming button **P** on a transmitter that has already been programmed in the receiver until the LED goes out.
2. To define the keyboard layout, press the **UP** button on the handheld transmitter as soon as the shutter/awning/blind begins to move upwards (after approx. 1 second).  
The shutter/awning/blind will come to a halt briefly.  
As soon as the shutter/awning/blind begins to move again, press the **DOWN** button on the handheld transmitter.  
The shutter/awning/blind will come to a stop.  
The transmitter or this channel has been successfully programmed.



**Note:** If more than one receiver is connected to the same supply lead, all of these will be in programming mode simultaneously. The shutters/awnings/blinds will begin to move up and down “at random”. The longer you take to carry out the programming, the larger the offset will be.

Individual channels can now be assigned to the given receiver.

To stop the brief up and down movements, press the **STOP** button on one of the pre-programmed handheld transmitters briefly.

Channel assignment/modification can now be carried out without you having to disconnect individual receivers.

If the shutter/awning/blind moves in the wrong direction, the transmitter must be deleted and re-programmed.

	Roller shutter	Awning	Venetian blind
			
Pos ▽	Intermediate position	Intermediate position	Intermediate position
Pos △	Ventilation position	Canopy tension	Reverse position

- Programming Pos ▽**
- Prerequisite:** The transmitter has been programmed and the end limit positions have been set. The curtain/canopy/blind is in the upper end limit position.
1. Adjust the curtain/canopy/blind into the desired position using the **DOWN** button.  
**Note:** Keep the **DOWN** button pressed until the desired position is reached.
  2. When the curtain/canopy/blind has reached the desired position, press the **STOP** button **in addition**. The curtain/canopy/blind will come to a stop. The intermediate position has been successfully programmed.

- Programming Pos △**
- Prerequisite:** The transmitter has been programmed and the end limit positions have been set. The curtain/canopy/blind is in the lower end limit position.
1. Move the curtain/canopy/blind in the **UP** direction using the handheld transmitter until the ventilation slits are open or the reverse position has been reached.  
**Note:** Keep the **UP** button pressed until the desired position is reached.
  2. When the curtain/canopy/blind has reached the desired position, press the **STOP** button **in addition**. The curtain/canopy/blind will come to a stop. The ventilation/reverse position has been successfully programmed.

### Adjustment to Pos ▽

**Prerequisite:** The transmitter has been programmed.

1. Press the **UP** button twice in **quick succession**.
2. The drive will adjust the curtain/canopy/blind into the stored intermediate position. If no intermediate position is stored, the curtain/canopy/blind is automatically adjusted into the lower limit position.

### Adjustment to Pos △ (roller shutter, awning)

**Prerequisite:** The transmitter has been programmed.

1. Press the **UP** button twice in **quick succession**.
2. The curtain/canopy is adjusted into the stored ventilation position. If no ventilation position is stored, the curtain/canopy is automatically adjusted into the upper limit position.

### Adjustment to Pos △ (venetian blind)

**Prerequisite:** The transmitter has been programmed.

1. Press the **UP** button twice in **quick succession**.
2. The blind is adjusted into the stored reverse position. If no reverse position is stored, the blind is automatically adjusted into the lower limit position.

### Deleting Pos ▽

1. Press the following buttons **simultaneously**:
  - **DOWN** button
  - **STOP** button
2. Keep these two buttons pressed until the LED goes out briefly.

### Deleting Pos △

1. Press the following buttons **simultaneously**:
  - **UP** button
  - **STOP** button
2. Keep these two buttons pressed until the LED goes out briefly.

### Deleting individual transmitters

Disconnect the fuse – and reconnect after a few seconds.

1. Open the front cover on the device and press the following buttons **simultaneously**:
  - Programming button **P**
  - **STOP** button
2. Keep these two buttons pressed until the LED goes out briefly.

### Deleting all transmitters

Disconnect the fuse – and reconnect after a few seconds.

1. Open the front cover on the device and press the following buttons **simultaneously**:
  - Programming button **P**
  - **UP** button
  - **STOP** button
  - **DOWN** button
2. Keep these buttons pressed until the LED flashes 3 times.

### Technical data

Operating voltage	3 V DC
Battery requirements	2 x LR 03 (AAA)
System of protection	IP 20
Permissible ambient temperature	–10 to +55 °C
Operating frequency	915,3 MHz
Dimensions in mm	L 121 x W 43 x H 23

The maximum radio operating range is 25 m indoors and 350 m outdoors.

**Battery replacement**

- 1. Open the battery compartment.
- 2. Remove the batteries.
- 3. Insert the new batteries **properly**.

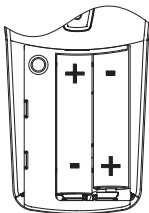

**Cleaning**

Clean the device with a damp cloth only.  
Do not use a cleansing agent as doing so may damage the plastic.

**Troubleshooting**

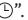
Problem	Cause	Remedy
Drive is not functioning. Transmission control light is not illuminated.	1. Batteries are empty. 2. Batteries are inserted incorrectly.	1. Replace batteries 2. Remove batteries and re-insert properly.
Drive is not functioning. Transmission control light is illuminated.	1. Receiver is not within radio operating range. 2. Transmitter is not programmed in receiver.	1. Move receiver closer to ensure it is within operating range. 2. Programme transmitter.
Transmission control light is flashing.	Battery power is low.	Replace batteries.
Automatic switching commands are not carried out.	The LumeroTel-g15 is in "Manual  .	Adjust the LumeroTel-g15 to "Auto  .
Drive moves in wrong direction.	The directions have been set incorrectly.	Delete transmitter and re-programme correctly.

**General declaration of conformity:**

The company elero GmbH hereby declares that the LumeroTel-g15 handheld transmitter complies with the basic requirements and other relevant regulations of the EC Directive 1999/5/EG.